



Boho Blue Retiform Cheerful Daisies Card



Supply List

All supplies can be purchased in my online store, this project is Retiform Technique Cheerful Daisies Card. You can add all items to your cart and then remove what you don't need.

Boho Blue Retiform
Cheerful Daisies Card
By Vanessa Baker



Measurements

Paper	Number of Pieces	Metric Measurement	Imperial Measurement
Boho Blue Cardstock	1	14.9cm x 21cm Scored at 10.5cm	5 ½" x 8 ½" Scored at 4 ¼"
Basic White Cardstock – Layer	1	10cm x 14.4cm	4" x 5 ¼"
- Stamping	1	9.5cm x 14cm	3 ¾" x 5"
- Die Cut Flower	1	5.5cm x 6.5cm	2 1/8" x 2 ½"
Boho Blue Cardstock - Die Cut Leaves	1	5cm x 8cm	2" x 3 ¼"
Masking Paper	3	4.2cm x 17.7cm	1 5/8" x 7"
Basic White Cardstock – Inner	1	10cm x 14.4cm	4" x 5 ¼"

Instructions

1. Cut all the cardstock layers and pieces needed as stated in the measurement guide. Cut and score the card base as stated, scoring and folding in half.
2. We will be using the masking paper to mask areas of the cardstock. So, with each piece of masking paper, before you use them, stick them a few times to your clothing to pick up some lint. This ensures they won't be as sticky; we don't want to tear the cardstock.
3. Place the first 2 pieces of masking paper from top to bottom angled to the right as shown. The area in the centre is where we will sponge using Boho Blue ink. You are stamping over this so don't make it too dark.
4. Then carefully remove the masking paper and mask the next area from left to right as shown. Sponge this area between the masking paper only, you can go over the parts that are already sponged. Pay particular attention to the edges, we need a nice crisp line on the sponged side of the masking paper.

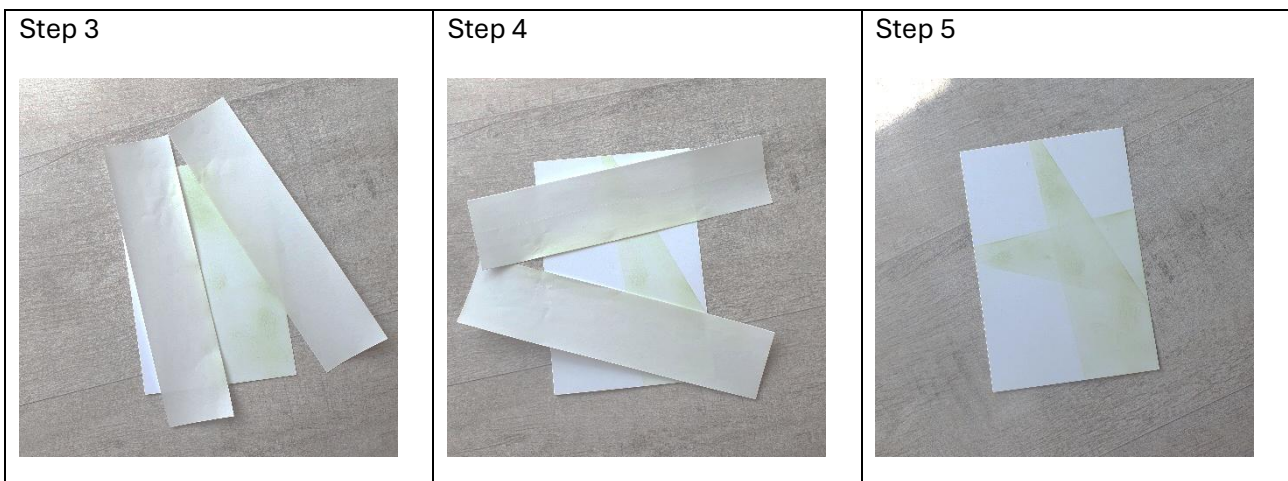

5. You have now created a series of shapes on the basic white layer which we are going to stamp into. You need to mask off each shape before you stamp and carefully move the masking each time, so you don't stamp over an area you have already done. You can also use post it notes or similar when you need more than 3 pieces of masking. It's best to watch the [video](#) to see what I mean.
6. Do the stamping in Boho Blue ink. NB: Because you are stamping over the masking paper there is a slight ridge, this results in the stamps missing a thin line just before the masking paper. While this is noticeable as you are stamping once the card is done you don't notice. You can apply a little more pressure to these areas when stamping.
7. The stamping can go in any direction, chose stamps to work with the shapes but also pay attention that you don't use the same one directly next to each other or too often. I used stamps from the Cheerful Daisies stamp set.

8. Once the stamping is completely done remove all the masking paper. Grab the sponge again with the Boho Blue ink and sponge lightly over the areas that still have a white background just to tone them in so there isn't such a big contrast.
9. Adhere the stamped layer to the Basic White layer and then onto the card front.
10. Die cut the white daisy and Boho Blue leaves using the Cheerful Daisies Dies. Stamp the centre for the daisy using Boho Blue and die cut.
11. Attach the leaves with liquid glue and the daisy with glue dots, add the centre to the flower with liquid glue.
12. Place 3 Boho Blue In Colour Dots.
13. Stamp a smaller daisy on the inner using Boho Blue ink. Adhere inside the card.



Video Tutorial Click below

[Boho Blue Retiform Cheerful Daisies Card Video](#)